

## HPNPS-2xZ150A6VF459A18V

### Positive and Negative Pulse Plating Rectifier

#### 1.Specifications:

Input parameters: Three-phase AC440V  $\pm$  10% 50Hz, three-phase unbalance  $\leq$ 5%, in line with national power quality standards

Output voltage: 2\*+6V/2\*-18V

Output current: 2\*+150A/2\*-459A

Cooling method: Water cooling

Power supply type: Pulsed power supply

Application Industry: Surface treatment industry, including PCB plating, rare metal plating, precision design, precious metal plating, electrolytic polishing, etc.

#### 2.Product Description

Electroplating is a surface treatment technique that deposits a thin layer of metal or alloy onto another material through electrolysis. It enhances wear resistance, conductivity, reflectivity, and corrosion resistance while improving aesthetics. Various types, such as copper, nickel, gold, palladium-nickel, tin-lead, silver, zinc, ABS, and chrome plating, are widely used in the surface treatment industry. Pulse Plating Rectifiers and PCB Plating Rectifiers play a vital role in achieving precise and efficient results.

The electroplating process involves key components: a cathode (the object to be plated), an anode (the plating metal or an insoluble anode), a plating solution containing metal ions, a storage tank, and a rectifier to supply direct current (DC). Pulse Plating Rectifiers, known for their adjustable output waveforms, are commonly used to ensure efficient and effective surface

treatment. These rectifiers are particularly valuable in applications like PCB plating, where precision and stability are critical.

Pulse Plating Rectifiers are highly regarded in the surface treatment industry for their energy efficiency, output stability, and adjustable waveforms. These features make them ideal for diverse applications, including PCB Plating Rectifiers used in electronics manufacturing. Their ability to deliver consistent performance ensures high-quality results in processes like copper, nickel, and chromium plating.

Electroplating is widely applied in industries such as automotive, where it serves both functional and aesthetic purposes. It is also used for ABS material surface treatment, enhancing durability and appearance. In electronics, PCB Plating Rectifiers are essential for PCB electroplating, ensuring reliable and precise metal deposition. The versatility of Pulse Plating Rectifiers makes them indispensable in achieving superior surface treatment outcomes.

### 3.Product Applications

The Plating Rectifier Equipment series of electroplating rectifiers serves a wide range of surface treatment applications. These include PCB electroplating, hard chrome coating, and plating with copper, nickel, zinc, gold, and silver, among other hardware surface treatments.

1)Field application diagram:



## 2) Industry application examples:

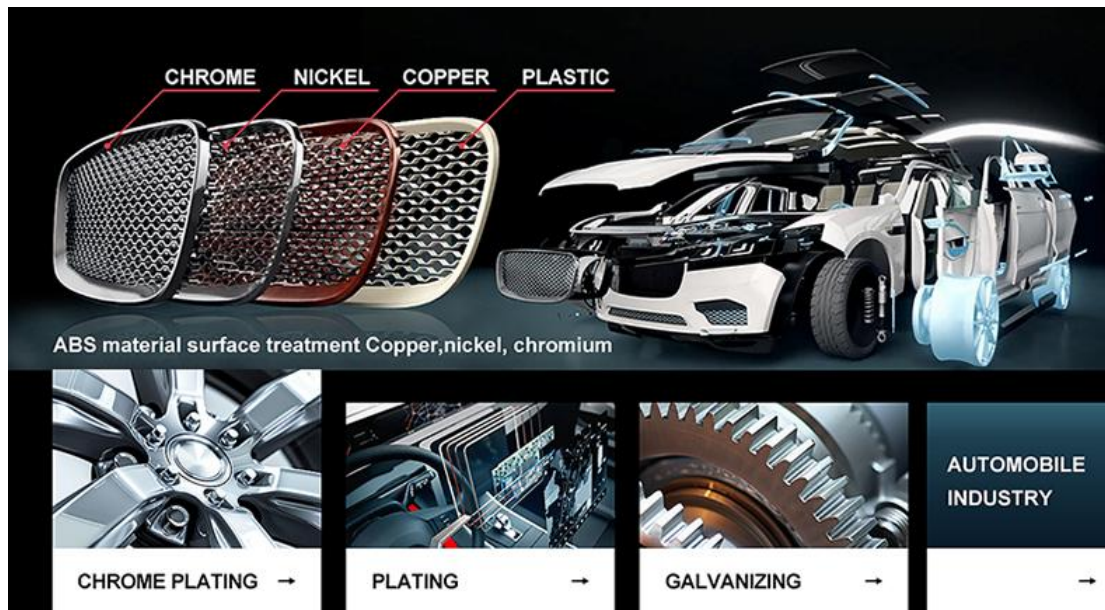

Automobile industry, ABS material surface treatment, Copper, nickel, chromium

## 4. Technology Advantages

Characteristics of an electroplating rectifier:

› Excellent Energy-Saving Effect:

The rectifier is designed to operate efficiently, converting incoming AC power into DC power with minimal energy loss. This leads to significant savings in electricity consumption, which can be particularly beneficial for large-scale electroplating operations that require continuous power supply.

› High Output Stability:

The rectifier is capable of maintaining a constant and stable DC output voltage and current, even under varying load conditions. This ensures consistent and uniform plating thickness, which is crucial for achieving high-quality electroplating results.

› Flexible Output Waveform Modulation:

The output waveform of the rectifier can be easily modulated to suit different electroplating processes and requirements. This includes adjusting the pulse

width, frequency, and duty cycle of the output waveform, which can optimize the plating efficiency and quality for specific applications.

› Ease of Waveform Modulation:

In addition to flexibility, the rectifier is also designed for ease of waveform modulation. Operators can quickly and accurately adjust the waveform parameters using intuitive controls or automated systems, allowing for precise control over the electroplating process.

Overall, these characteristics make the electroplating rectifier an essential tool for achieving high-quality, efficient, and energy-saving electroplating processes.

## **5.Role of electroplating**

› Enhance Wear Resistance, Conductivity, and Reflectivity:

By depositing a thin layer of a harder or more conductive material onto an object's surface, electroplating significantly improves wear resistance. This allows the object to withstand friction and abrasion more effectively. Additionally, electroplating enhances conductivity, especially in electronic and electrical components, by providing a smoother and more uniform surface for current flow. Certain metals, such as silver and chromium, can also improve reflectivity, making electroplated surfaces ideal for mirrors, reflectors, and optical applications.

› Improve Corrosion Resistance:

Electroplating creates a protective barrier between the base material and the environment, shielding the object from corrosive elements like moisture, oxygen, and chemicals. This significantly extends the object's lifespan by preventing rust and degradation.

› Enhance Aesthetics:

Electroplating adds a decorative finish to objects, enhancing their visual appeal. For example, the shiny chrome finish on car bumpers or the gold

plating on jewelry adds elegance and sophistication. This dual functionality of electroplating—improving both performance and appearance—makes it a valuable process in various industries.

## 6.Types of electroplating

### **Copper Plating:**

**Purpose:** Primarily used as a primer to enhance adhesion of subsequent plating layers and improve corrosion resistance.

**Considerations:** Copper is prone to oxidation, which forms copper oxide (copper green) that loses conductivity. Therefore, copper-plated products must undergo copper protection treatments.

### **Nickel Plating:**

**Purpose:** Used as a primer or for aesthetic purposes to enhance corrosion resistance and wear resistance. Chemical nickel plating is a modern process that offers wear resistance comparable to chrome plating.

**Considerations:** Note that many electronic products, such as DIN heads and N heads, no longer use nickel as a primer due to its magnetic properties, which can affect the electrical performance and passive intermodulation inside the device.

### **Gold Plating:**

**Purpose:** Improves conductive contact impedance and enhances signal transmission.

**Considerations:** Gold is highly stable but also the most expensive option.

### **Palladium-Nickel Plating:**

**Purpose:** Improves conductive contact impedance and enhances signal transmission. Offers better wear resistance than gold.

**Advantages:** Combines the benefits of palladium's corrosion resistance and nickel's hardness.

### **Tin-Lead Plating:**

Purpose: Improves soldering ability.

Considerations: Due to concerns about lead content, tin-lead plating is being phased out and replaced by alternatives such as bright tin and mist tin plating.

### **Silver Plating:**

Purpose: Improves conductive contact impedance and enhances signal transmission.

Advantages: Silver offers the best electrical conductivity among these metals and is relatively resistant to oxidation, maintaining conductivity even after oxidation.

Considerations: While silver's performance is excellent, its cost and tendency to tarnish over time should be considered.

the choice of plating type depends on the specific requirements of the application, including corrosion resistance, wear resistance, electrical conductivity, cost, and environmental considerations.

## **7.Elements of Electroplating**

**Cathode:** The plated object, specifically referring to various connector terminals or other metallic surfaces that are intended to receive the electroplated coating. The cathode serves as the surface where the desired metal ions are reduced and deposited as a solid layer.

**Anode:** Depending on the type of electroplating process, the anode can be either soluble or insoluble.

**Soluble anode:** This is the metal that is to be plated onto the cathode. During the electroplating process, metal ions from the anode dissolve into the plating solution and are then plated onto the cathode.

**Insoluble anode:** In some cases, especially when using precious metals like white gold or iridium oxide, an insoluble anode may be used. This anode does not dissolve during the process but serves as a source of electrons for the reduction reaction that occurs at the cathode.

**Plating Solution:** This is a solution that contains ions of the metal that is to be plated onto the cathode. The composition and concentration of the plating solution are crucial for achieving the desired plating properties, such as thickness, adhesion, and appearance.

**Plating Tank:** The tank that holds and stores the plating solution during the electroplating process. The tank must be able to withstand the corrosive effects of the plating solution and maintain a constant temperature to ensure consistent plating results. Strength, corrosion resistance, temperature resistance, and chemical compatibility are key considerations in selecting the material for the plating tank.

**Rectifier:** The equipment that provides the direct current (DC) power supply for the electroplating process. The rectifier converts alternating current (AC) from the main power supply into DC, which is then used to drive the electroplating reaction. The voltage and current output of the rectifier can be adjusted to control the rate of deposition and the thickness of the plated layer.

Additionally, other elements may also be involved in the electroplating process, such as filters to remove impurities from the plating solution, heaters to maintain the solution at a constant temperature, and stirrers to ensure uniform mixing of the solution.

## 8.Component Part for Electroplating

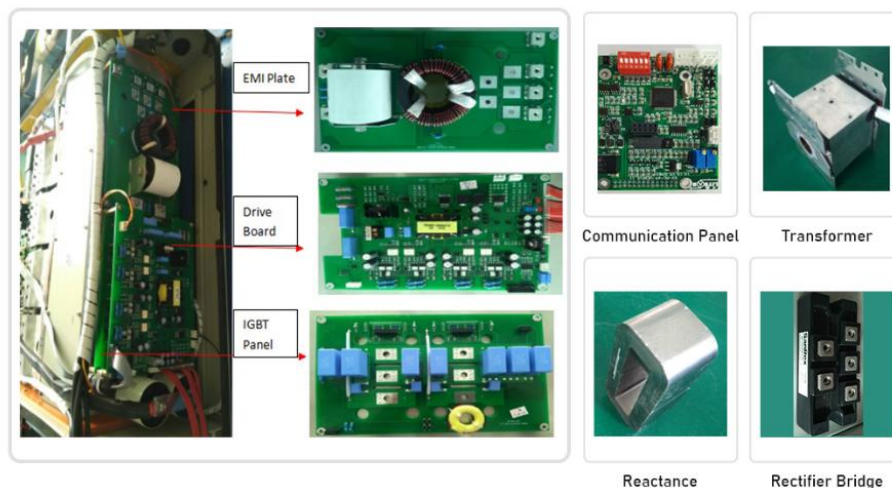

## 9.Cooling Type for Electroplating

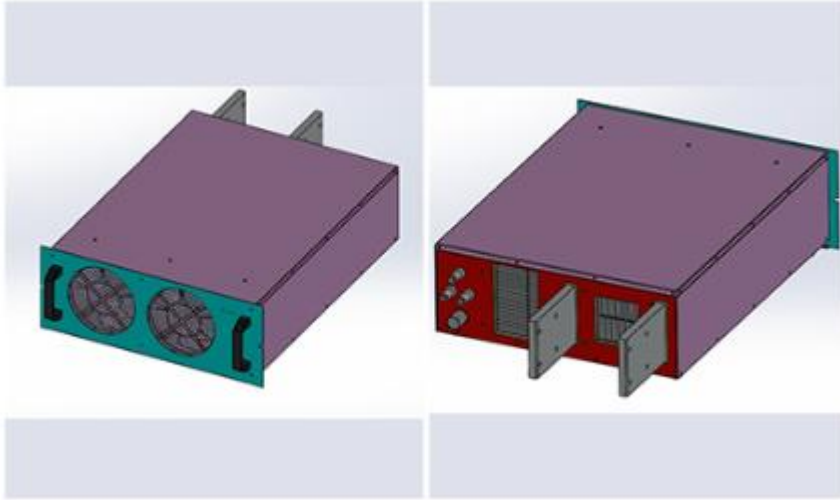

Air Cooling: Heat dissipation fan + air duct + comb heat sink

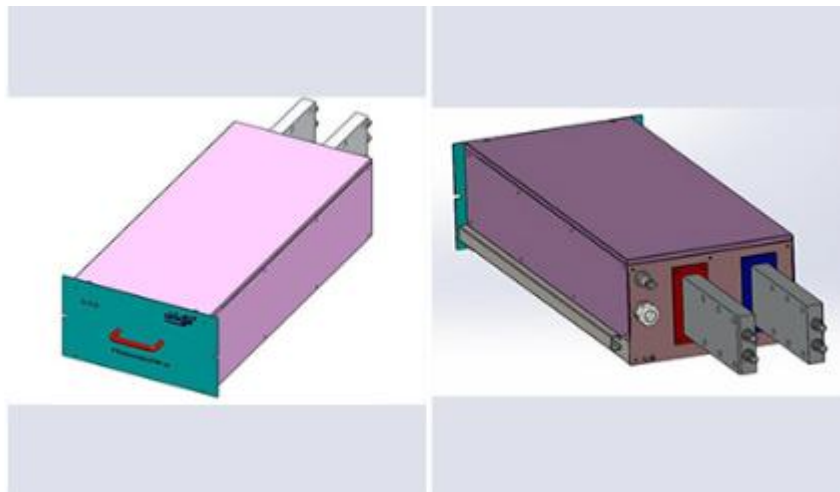

Water Cooling: Built-in water circulation line



## 10. Technical Parameters

Characteristics type	Parameter item	Technical requirements
Input characteristics	Rated input voltage	Three-phase AC440V $\pm$ 10% 50Hz, three-phase unbalance $\leq$ 5%, in line with national power quality standards
	Rated input current	AC3.1A
	Rated input power	2.3KVA
	Rated input power factor	COS $\Phi$ $\geq$ 0.95
Output characteristics	Output voltage	2*+6V/2*-18V
	Output current	2*+150A/2*-459A
	Rated current stabilization accuracy	$\leq$ 2%
	Rated voltage accuracy	$\leq$ 2%
	Display accuracy	0.1A, 0.01V
	Rated current ripple factor	$\leq$ 3% of rated current
	Rated output efficiency	$\geq$ 90%
	Number of output channels	2-way
Insulation characteristics	Insulation resistance	Input-output: $\geq$ 5M $\Omega$
		Input-enclosure: $\geq$ 5M $\Omega$
		Output - enclosure: $\geq$ 5M $\Omega$
Protection characteristics	Self-protection function under abnormal conditions such as overvoltage, overcurrent, overload, short circuit and overheating	
Other	Noise	$\leq$ 75dB

characteristics	Health status	The product can operate continuously at full load
	Load rating	Pole II
	Insulation class of transformer	Class B
	Weight	About 55KG

## 11.Solution

Liyuan will keep up with the world's latest technology closely, and uphold the concept of providing customers with high-quality power supplies and professional integrated services.

With advanced design and rich experience in rectifier manufacturing, we will provide the best power solutions as well as the most stable and efficient power supply for users both at home and abroad.

## 12.Technical Capability

LIYUAN rectifier is the most competitive brand in China

Company relies on strong technology research and development cooperation basis, created a number of advanced technology, in recent 3 years amounted to more than 30 to apply for a patent, which has nearly 10 patents of invention. Equipped with the national electric power transformation and control engineering technology research center (branch), and has set up a loan enterprise academician workstation.

Strict implementation of ISO quality management system, and through the CE safety certification, has been implementing ERP management for many years, to achieve the network, systematic computer control, the formation of a standard, efficient modern management system.

### 13. Qualification certification

Liyuan adhere to innovation and the continuous improvement of power conversion efficiency and product quality.

The increasing R&D investment every year, and cooperation with China's well-known universities, we has established the research center of national electric power conversion and control engineering technology.

Especially the related core patents of high-power synchronous rectifier power supply, stay ahead of the whole industry in China.

The ISO 9001 quality management system has been fully implemented in Liyuan, including quality inspection of components in warehouse, production process inspection, and final product inspection.

We adopt advanced scientific quality management system and the most stringent testing methods in the whole process to ensure the stability and reliability of products.



### 14. Service

#### Packing

- 1) Small size rectifier packing in carton box separately.
- 2) Large size rectifier will be packed in wooden case.
- 3) We guarantee that all the packing is intact when it reaches its destination.

#### Shipping

- 1)30-45 Days after payment.
- 2)Transport: DHL, FEDEX, UPS, Air shipping, Boat shipping
- 3)You may choose our shipping partner or your own partner.

### **Maintenance**

We are pleasant to share our theory and experience on equipment maintenance with users.

We are pleasant to interact with users to collect their tips and know-hows on equipment maintenance.

The module “Maintenance” here is intended to help users solve various problems they possibly encounter during equipment maintenance...

If you need other power electroplating rectifiers, we can custom design them according to customer requirements. Please contact us.

Are you looking for HPNPS-2xZ150A6VF459A18V Positive and Negative Pulse Plating Rectifier? Liyuan Haina Group is one of the professional manufacturers and suppliers in this field. With over 27 years of focus on R&D, design, production, sales, and technical services for industrial rectifiers, we have already exported our products to the United States, Canada, Britain, Italy, Spain, South Africa, Russia, the UAE, Japan, South Korea, Malaysia, and other parts of the world. Equipped with a productive factory, we warmly welcome you to purchase our high-quality, Made-in-China products at competitive prices or try our customized service.